



RAND
POLYPRODUCTS PVT. LTD.

PuCRETE®



POLYDEC® CP

Revolutionary overlay solutions for exclusive car park environments

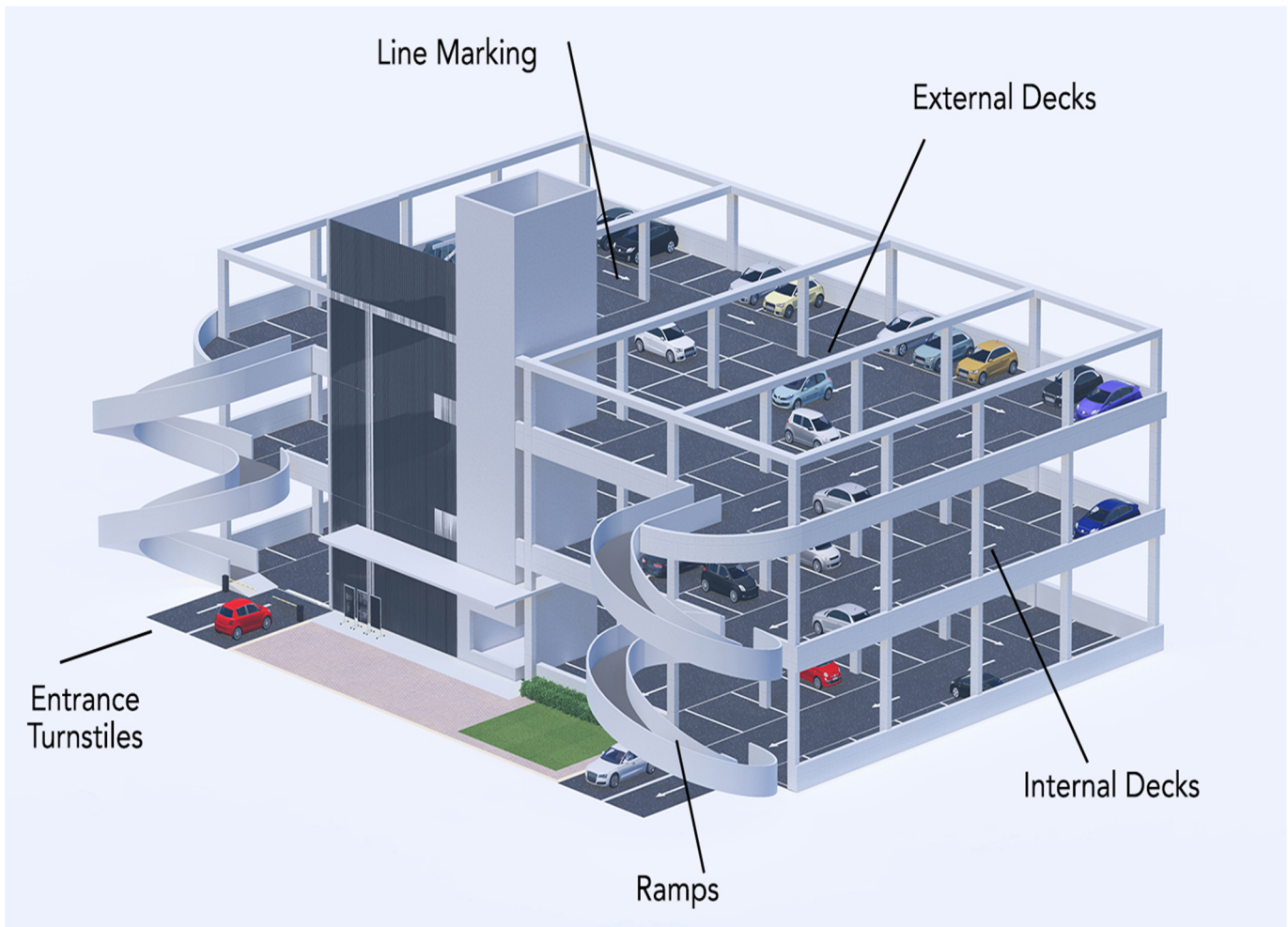

Elegant, opulent and plush; these are synonymous with any modern-day commercial destination. Car parks are often your point of access at such places and an aesthetically pleasing parking makes for a good impression upfront. It is of late that developers have realized this aspect and look for effective ways to make for a pleasing car-park experience.

Often overlooked, the right synergy between water-proofing and surface coating materials is critical in delivering long-term protection to the sub-floor, while maintaining a seamless and visually pleasing appearance to the car park; along with structural integrity to provide a safe facility for car park operators and vehicle owners. RPPL, through its PUCRETE® family, brings to you POLYDEC®CP; a fool-proof car park protection overlay system.

Consisting of a heavily cross-linked polyurethane matrix, the system is completely impervious and displays exceptionally high impact resistance, toughness, abrasion cum slip resistance and chemical resistance at comparable compressive strength to the base-slab.

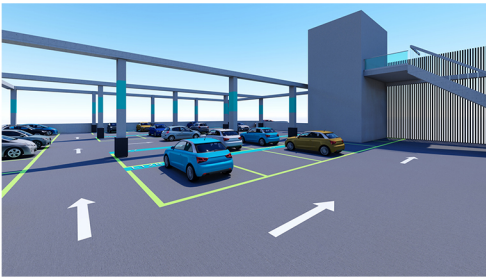

POLYDEC®CP system consists of multi-layered coats designed to provide total protection to the sub-floor. The system is solvent-free, low VOC and results in a water-tight, tough, anti-skid surface topped with a solvent-free UV stable PU coat to provide excellent film strength and scratch resistance.

Benefits -

- Protect sub-floor from any damage & wear-tear.
- Provides an aesthetically pleasing & safe driving environment while using the car park.
- Low in VOC and solvent free.
- Reduces slip and unwanted squealing noise from vehicle tires.
- Tough and resistant to abrasion as well as any heavy impact loads.
- Excellent chemical resistance to all engine oils, battery acids, hydraulic oils etc.
- Excellent inter-layer adhesion and bond to sub-floor, resulting in complete non-peeling of the paint.
- Totally seam less floor with a complete blister-proof underlay.
- Easy to clean and maintain.
- Seamless, flexible floors; ensuring high resistance to cracking due to joints. 100% UV stable – non yellowing – top coat

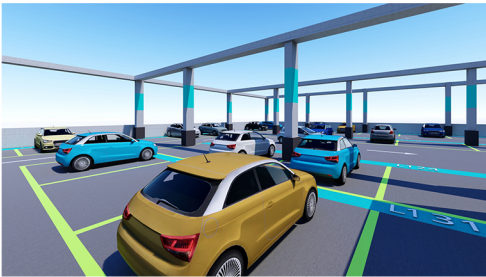

Standard Color Chart

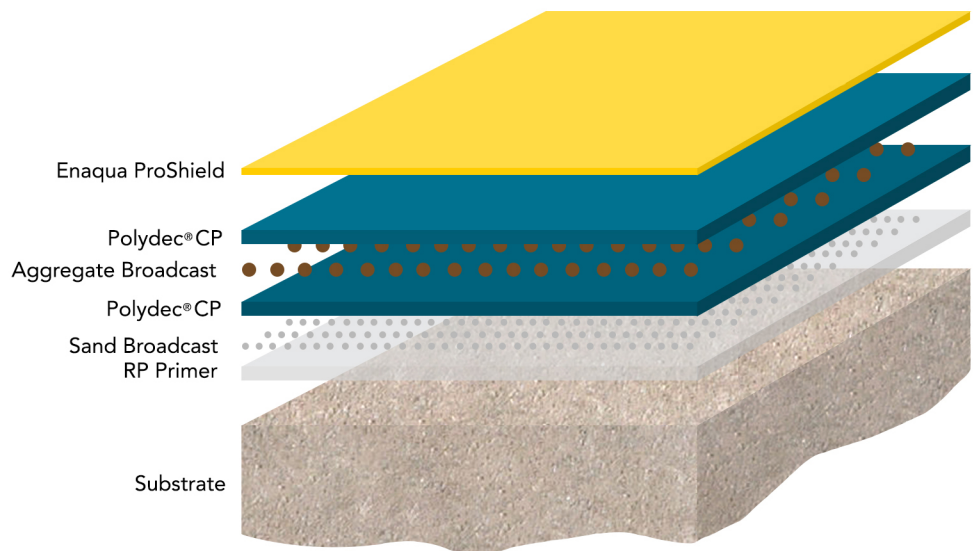

The actual appearance/tone of the color may differ from the shades shown above. Our technical team will assist you in providing a true color sample/color matching for special requirements.

Substrate Pre-requisites:

Well-levelled and finished concrete substrate, with a recommended strength of 20 -25 MPa. Floor should be well levelled with minimum possible undulations. Substrate should be free from rising damp and ground water pressure and dry up to 75% RH.

Overlay kit details:

RP Primer	2 component Epoxy primer, 2 coats recommended
	Epocoat 3144 - 30 kgs Hardener EP 35 - 30 kgs
PolyDec®CP	Scratch base coat, supplied in kits that includes 4 components;
	Enaqua 1141 - 2.8 kgs Hardener PU 23 - 3.0 kgs CP Filler set - 4.1 kgs Pigment paste - 0.5 kgs
	Coverage up to 18 Sqm per kit
CP Quartz	Broadcast aggregates - 25.0 kgs per PolyDec® CP kit
PolyDec®CP	Scratch top coat, supplied in kits that includes 4 components;
	Enaqua 1141 - 2.8 kgs Hardener PU 23 - 3.0 kgs CP Filler set - 4.1 kgs Pigment paste - 0.5 kgs
	Coverage up to 18 Sqm per kit
Enaqua ProShield	2-component solvent free, UV stable PU paint. 2 coats recommended
	Enaqua 1154 - 4.0 kgs Hardener PU 54 - 1.0 kg
	Coverage - Up to 8 Sqm/kg

Service Installation:

The system comes in pre-weighed kits which are mixed on site and can be laid as an in-situ casting. The recommended overlay thickness for car parking bays is 2.0 - 2.5 mm. Polydec® CP must be ideally laid-over ready and finished slabs (subfloors for ground floor- level), at its recommended thickness. The overlay is done by mixing the 4 components of the kit on site and troweled as an in-situ laying. The overlay is finished with a UV stable solvent-free PU paint.

Technical Data:

The following technical data is of Polydec®CP samples cured for 7 days at ambient temperature, at an RH of 50%.

Density, gm/cc	2.15 +/- 0.1
Strength under tension, N/mm ² ASTM D638	4.56
Compressive Strength, N/mm ² ASTM C579	41.4
Flexural strength, N/mm ² ASTM D790	13.79
Drop Impact Strength - First crack, Joule/m	16000
Drop Impact Strength - Ultimate failure, Joule/m	23500
Water absorption, ml (CP.BM 2/67/2) , ASTM D570	0.38%
UV resistance (Final Top coat)	Excellent (non-yellowing)

Curing:

Polydec® CP screed will cure for partial traffic operation within 12 hours and for full traffic post 24 hours. However, it will gain its complete strength in 7 days. For best results, the application temp. should be within a range of 15 to 25 O C. The maximum temperature Polydec® CP flooring overlay will withstand for continuous exposure will be up to 65 O C.

Chemical Resistance:

Most diluted and concentrated organic acids such as, Acetic acid, Lactic Acid, Oleic Acid and Citric Acid as commonly found in the food industry; diluted and concentrated acids such as Hydrochloric, Nitric, Phosphoric, Sulphuric acid, etc.; diluted and concentrated alkalis, such as Sodium Hydroxide to 50% concentration It also resists animal fats and vegetable oils, sugars flavorings and essences. Mineral oils, kerosene, gasoline and brake fluids and a wide range of organic solvents including Methanol, Xylene, Ethers and Ketones.

Note: Some staining or discoloration may occur with some chemicals depending upon the nature of the spillage and the standards of housekeeping employed.

Aftercare and Maintenance:

Clean regularly using a rotary scrubber and a mild floor cleaner/detergent. Use respective cleaning-kits in case of chemical spillages to avoid prolonged exposure to chemicals.

For further details on the product, please contact us at

Rand Polyproducts Pvt. Ltd.,

Gat No. 3a/2, Old Gat No. 1649,
Village Ghotawade Village, Tal. Mulshi,
Dist. Pune, PIN - 412 115.

Contact:

Sales/Admin 020-6790 8609/10
Technical 020-6790 8621

Email:

rand@randpoly.in